



# Sequim High School

---

## Sequim High School Registration Guide -- 2024

*The Registration Forms will need to be returned to your student's English teacher by March 23<sup>rd</sup>.*

### Reference Information: *For you to keep*

- Registration Information and Sequim Middle School 8<sup>th</sup> Grade Registration Dates
- Sequim High School – contact information
- 24-Credit Graduation Requirement & Personalized Pathway information
- Sequim High Science Pathways
- SHS Bell Schedules / Campus Map
- Sequim High School Course Catalog 2020-2021 online at  
[http://shs.sequimschools.org/our\\_school/counseling/course\\_information](http://shs.sequimschools.org/our_school/counseling/course_information)

### Registration Forms: *These forms must be returned to SMS English teacher by March 23<sup>rd</sup>.*

- Student Health Information (goldenrod)
- Registration Planning Form DRAFT (white)

### Important Notes:

- Sequim High School Registration Planning Forms for 9<sup>th</sup> Grade Course Selection (blue) -- will be distributed during Registration.
  - 1) Students will not be able to take this sheet home, as it will contain their Skyward login information.
  - 2) Parents are encouraged to send a completed draft copy of the Registration Planning Form with their student so they can rewrite this information on the school form.

### Copies of these documents will be available:

- Sequim High School website under the counseling tab/scheduling procedures
- Emailed home to families by Sequim Middle School March 19<sup>th</sup>
- Sequim Middle School Office

## REGISTRATION INFORMATION

### COUNSELING DEPARTMENT -- SEQUIM HIGH SCHOOL

Melee Vander Velde, Counselor A-F, Sf-Z

Erin Fox, Counselor G-Se

Some things you will need to know about items in this packet:

1. Be sure to put your student's LEGAL NAME on the enrollment paperwork. Please return to Sequim Middle School English teacher by **March 23, 2020**.
2. **HONORS INTRODUCTION TO LITERATURE:**
  - Students who request Honors Introduction to Literature will receive a summer assignment.
3. **MATH:** Placement will be recommended by your student's Middle School Math teacher. Additional math information may be reviewed by the SHS staff, including test scores and academic history which may result in a math placement change.
4. **SCIENCE:** Three years of science are required for graduation. Incoming freshmen have three science options:
  - Integrated Science
  - Agricultural Science
  - PLTW Principles of Biomedical SciencePlease refer to the "Sequim High School Science Pathways" handout and the course catalog for further information.
5. **WORLD LANGUAGE:** It is highly recommended that entering freshman with less than a 2.0 GPA delay taking a world language class until the sophomore or junior year.
6. **MICROSOFT IMAGINE ACADEMY:** A required class for graduation. Students may test out of the class. Please note, passing the test does not earn high school or college credit.

The rigorous bypass test includes demonstration of skills and knowledge of Microsoft Word; Excel; Outlook; Power Point; Windows; Office 365; computer literacy; and touch-typing proficiency. The test is difficult and passing requires expert knowledge of Microsoft Office.

The testing dates are as follows:

- After school: Tuesday, May 19<sup>th</sup> or Thursday, May 21<sup>st</sup> at 3pm in room A4 or
- Before school: Wednesday May 20<sup>th</sup> or Friday May 22<sup>nd</sup> at 7 AM in room A2.

Exams last approximately one hour. If you have questions, contact Mrs. Ditlefsen:

[cditlefsen@sequimschools.org](mailto:cditlefsen@sequimschools.org) or Mr. Kleinberg: [ckleinberg@sequimschools.org](mailto:ckleinberg@sequimschools.org). See the following link for additional information, study guides, etc. <https://www.microsoft.com/en-us/learning/certification-overview-mos.aspx>

7. **ELECTIVES:** If your child picks an elective that is not available we will use their alternate courses. **Please make sure these courses are selected carefully.**
8. **24-CREDIT GRADUATION REQUIREMENT HANDOUT** – This important document details the new 24 credit high school diploma requirement established by Washington State. Information regarding the new "Personalized Pathway Requirement" option is also included. **PLEASE KEEP FOR FUTURE REFERENCE.**

OVER

**SEQUIM HIGH SCHOOL**  
**601 N. Sequim Ave.**  
**Sequim, WA 98382**

**MAIN OFFICE:** 360-582-3600 FAX: 360-681-8688

Principal:	Shawn Langston	<a href="mailto:shawnl@sequimschools.org">shawnl@sequimschools.org</a>
Principal on Spec Assignment	Vince Riccobene	<a href="mailto:vriccobene@sequimschools.org">vriccobene@sequimschools.org</a>
Asst. Principal:	Kristi Queen	<a href="mailto:kqueen@sequimschools.org">kqueen@sequimschools.org</a>
Athletic Director:	Dave Ditlefsen	<a href="mailto:dditlefsen@sequimschools.org">dditlefsen@sequimschools.org</a>
Principal's Secretary:	Ann Tjemsland	<a href="mailto:atjemsland@sequimschools.org">atjemsland@sequimschools.org</a>
Athletic Secretary:	Julie Lancheros	<a href="mailto:jlancheros@sequimschools.org">jlancheros@sequimschools.org</a>
Secretary/Bookkeeper:	Erin Ulm	<a href="mailto:eulm@sequimschools.org">eulm@sequimschools.org</a>
Nurse:	Sonja Bittner	<a href="mailto:sbittner@sequimschools.org">sbittner@sequimschools.org</a>

**ATTENDANCE:** 582-3608

Attendance: Laura Lestage [llestage@sequimschools.org](mailto:llestage@sequimschools.org)

**COUNSELING CENTER:** 582-3613 FAX: 360-582-9881

Counselors:	Melee Vander Velde	<a href="mailto:mvandervelde@sequimschools.org">mvandervelde@sequimschools.org</a>
	A - F and Sf - Z	
	Erin Fox	<a href="mailto:efox@sequimschools.org">efox@sequimschools.org</a>
Registrar:	G - Se	
	Dennise Kettel	<a href="mailto:dkettel@sequimschools.org">dkettel@sequimschools.org</a>
Secretary:	Terry Brundage	<a href="mailto:tbrundage@sequimschools.org">tbrundage@sequimschools.org</a>

**CAREER CENTER:** 582-3631

Career Specialist: Mitzi Sanders [mitzi@sequimschools.org](mailto:mitzi@sequimschools.org)

**WEB PAGE:**

District Page: [www.sequimschools.org](http://www.sequimschools.org) (Has a link to the High School page.)

**DAILY BULLETIN & COURSE CATALOG are ONLINE**

Both are available on the web. The *Daily Bulletin* is the primary method of communicating with the students on current information. The District web page links to the High School page. The bulletin and the course catalog are listed under Site Shortcuts.

**COMMUNICATING WITH TEACHERS:**

All teachers have e-mail and voice mail. To contact a teacher, call the main office and your call will be transferred. If the teacher is unable to take your call, you will be automatically connected to his/her voice mail. To obtain the e-mail address of any of the teachers, go to the District Web Page and click on Staff Directory.

## SEQUIM HIGH SCHOOL GRADUATION REQUIREMENTS

### Class of 2021 and Beyond

<b>English</b>	4.0
<b>Math</b>	Algebra I 1.0 Geometry 1.0 Algebra II 1.0  TOTAL 3.0
<b>Science</b>	3.0
<b>Social Studies</b>	WA State History 0.5 Modern World History 1.0 US History 1.0 Civics/CI 1.0  TOTAL 3.5
<b>Health</b>	0.5
<b>Physical Education</b>	1.5
<b>Microsoft Imagine Academy</b>	0.5 (can be used for CTE credit)
<b>Career Technical Education (CTE)</b>	1.0
<b>Art</b>	2.0 (1.0 can be PPR*)
<b>World Language</b>	2.0 (can be PPR*)
<b>Electives</b>	3.0
<b>TOTAL</b>	<b>24.0</b>

### Other Requirements

- Complete a comprehensive High School and Beyond Plan
- Complete at least one graduation pathway aligned with High School and Beyond Plan goals
- Complete the state required HIV/AIDS Prevention lesson

\*PPR = Personalized Pathway Requirements: Up to three locally determined courses that lead to a specific post-high school career outcome chosen by the student, based on the student's interest and their High School and Beyond Plan

**Running Start:** Students must meet all graduation requirements identified above, including all other requirements.

## GRADUATION PATHWAYS

Student's Goal: 1st Year After Graduation		Graduation Pathways: Class of 2021 and Beyond	
<b>High School and Beyond Plan</b>	Career/Technical Field (Additional postsecondary education/training, technical college, apprenticeship, or workforce entry)	<b>Graduation Pathway</b>	Complete sequence or CTE courses which includes the potential to earn college credit or earn an industry recognized credential
	Military Enlistment		ASVAB Score
	General Postsecondary Education (Two- or four-year college)		Smarter Balanced HS Assessment or WA-AIM (ELA and/or math)
			SAT or ACT scores on ELA and/or math sections
			Earn College Credit in ELA and/or math
			Transition Course in ELA and/or math
			AP Courses or Exams in ELA and/or math
			Combination of ELA and math option from any of the General Postsecondary Education Pathways

# SCIENCE

## Sequim High Science Pathways

**Three (3) credits** of science are required for graduation. Of these credits, at least one must be a life science and at least one must be a physical science. Below are some recommended course sequences, although moving between the different options is also possible. (L=Life Science, P= Physical Science, \*=fulfills CTE requirement)

\*\*\*Most colleges DO NOT count AP Computer Science A, Engineering, or Aerospace courses as “science” when considering students for admission. For college-bound students, these can be taken as CTE electives in addition to the core science classes. If a student is not college-bound, all these classes DO count toward the three years of science required for graduation.

	Option A	Option B	Option C	Option D	CTE/Science Electives
<b>Pathway Profile</b>	Intended for students who are not focused on one field of science	Intended for students who are particularly interested in natural resources or agriculture	Intended for students who are particularly interested in medical fields	Intended for students in accelerated courses and others interested in advanced pathways in science	Most Universities Do Not Count the Course Below as Science but They Do Count Toward the 3 Years of Science Required for Graduation
<b>Possible Careers</b>	Undecided	Agriculture or Natural Resource Management	Health Care	Science, Math, or Technology-based fields	Engineering or Computer Science
<b>Post High-School Goals</b>	Work Force, Community College, Technical School, or University	Work Force, Community College, Technical School, or University	Community College, Technical School, or University	University, including a School with Competitive Admissions	
<b>9th Grade Course</b>	Integrated Science I (P)	Agricultural Science (P*)	Principles of Biomedical Science (L*)	Principles of Biomedical Science (L*)	
<b>10th Grade Course</b>	Principles of Biomedical Science (L*), Agricultural Biology-Plant (L*), or Agricultural Biology-Animal (L*)	Agricultural Biology-Plant (L*) or Agricultural Biology-Animal (L*)	UW Chemistry (P)	UW Chemistry (P)	***Engineering I (P*)
<b>11th Grade Course</b>	Chemistry (P), Physics (P), UW Astronomy (P), or See Options in Other Pathways	Chemistry (P), Veterinarian Science (L*), or Food Safety Science (P*)	Human Body Systems (L*)	AP Biology (L)	*** Engineering II Aerospace (P*)
<b>12th Grade Course</b>	See Options in Other Pathways	Chemistry (P), Veterinarian Science (L*)	Medical Interventions (L*)	AP Physics (P)	***AP Computer Science A (P*)

<b>Regular Bell Schedule</b>		
<u>Period</u>	<u>Bell Time</u>	<u>Mins.</u>
1	8:15-9:15	60
2	9:20-10:15	55
3	10:20-11:15	55
<b>1st Lunch</b>	11:15-11:45	30
4B	11:20-12:15	55
<b>2nd Lunch</b>	12:15-12:45	30
4A	11:50-12:45	55
5	12:50-1:45	55
6	1:50-2:45	55

<b>2-Hour Delayed Start</b>		
<u>Period</u>	<u>Bell Time</u>	<u>Mins.</u>
1	10:15-10:55	40
2	11:00-11:35	35
3	11:40-12:15	35
<b>1st Lunch</b>	12:15-12:45	30
4B	12:20-12:55	35
<b>2nd Lunch</b>	12:55-1:25	30
4A	12:50-1:25	35
5	1:30-2:05	35
6	2:10-2:45	

<b>Monday PDM/Den</b>		
<u>Period</u>	<u>Bell Time</u>	<u>Mins.</u>
1	9:15-9:55	40
2	10:00-10:40	40
<b>DEN</b>	10:45-11:15	30
3	11:20-12:00	40
<b>1st Lunch</b>	12:00-12:30	30
4B	12:05-12:45	40
<b>2nd Lunch</b>	12:45-1:15	30
4A	12:35-1:15	40
5	1:20-2:00	40
6	2:05-2:45	40

<b>Monday PDM/ NO Den</b>		
<u>Period</u>	<u>Bell Time</u>	<u>Mins.</u>
1	9:15-10:05	50
2	10:10-10:55	45
3	11:00-11:45	45
<b>1st Lunch</b>	11:45-12:15	30
4B	11:50-12:35	45
<b>2nd Lunch</b>	12:35-1:05	30
4A	12:20-1:05	45
5	1:10-1:55	45
6	2:00-2:45	45

STUDENT PARKING

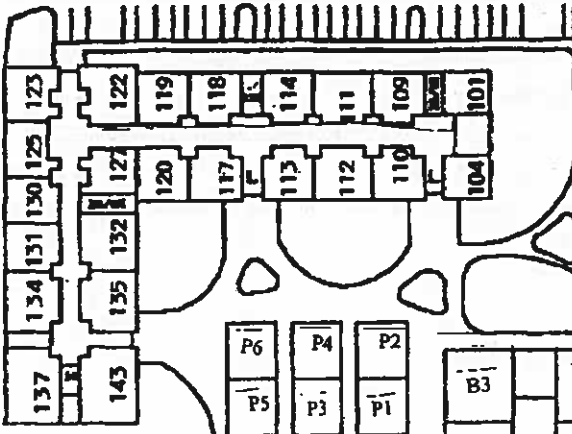

FACULTY PARKING

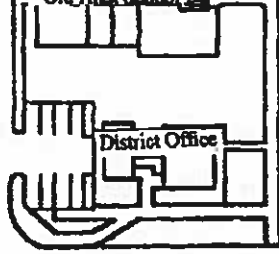
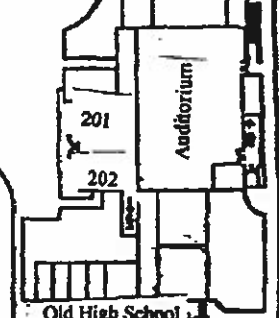
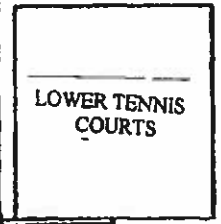
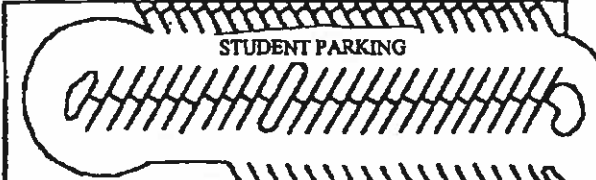
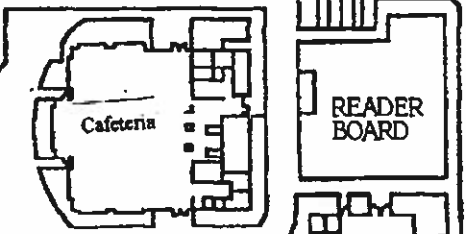
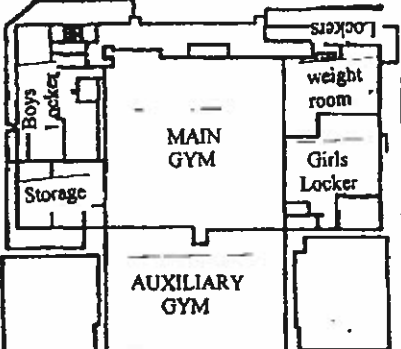
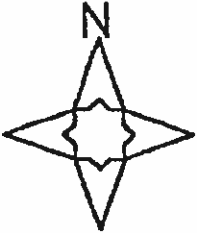
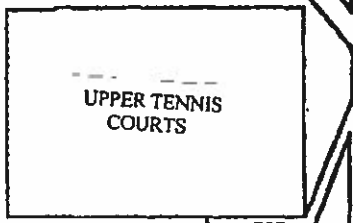
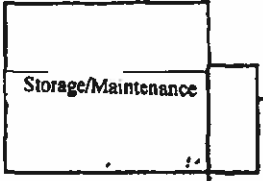
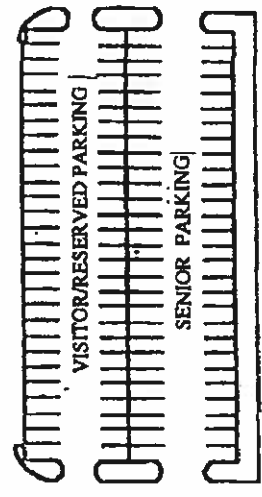
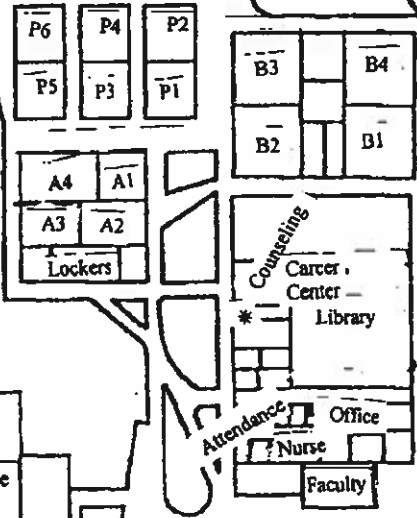
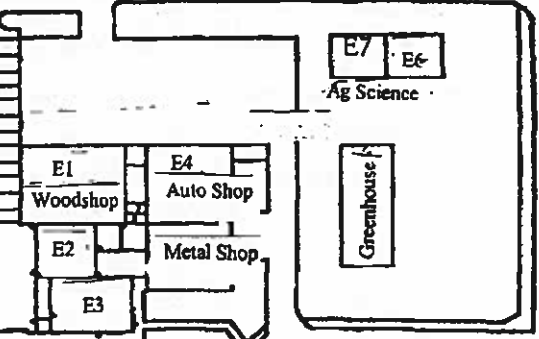

FIR STREET

FIR STREET

501 NORTH SEQUIM AVENUE

NORTH SEQUIM AVENUE

BAND ROOM



# Sequim School District No. 323

"Engage Empower Thrive"

## STUDENT HEALTH INFORMATION

This questionnaire is designed to aid school staff in anticipating any health concerns that might affect your child's safety or learning.

STUDENT LEGAL NAME \_\_\_\_\_  
First Middle Last

GRADE: \_\_\_\_\_ GENDER: \_\_\_\_\_ DOB: \_\_\_\_\_

### LIFE-THREATENING CONDITIONS

Does your child have a life-threatening health condition?  Yes\*  No

**Washington State Law requires that medication or treatment orders and a health care plan be in place prior to starting school.**

### MEDICAL HISTORY\*

Indicate your child's potentially life threatening diagnosis and medication prescribed:

\*Please contact Health Services for necessary care plan forms (also available on SSD website).

- Diabetes  Epilepsy/seizure disorder  Bleeding disorder
- Asthma  Cardiac condition
- Allergy with potential for anaphylaxis to (i.e. food, bee stings): \_\_\_\_\_
- Special Health Care needs/physical conditions: \_\_\_\_\_

### MEDICATION

Will medication be needed at school?:  Yes\*  No If yes, name of medication: \_\_\_\_\_

Reason: \_\_\_\_\_

**\*If your child needs to take medication at school, please contact the office for the necessary authorization form. This form must be completed prior to the administration of any medication at school.**

Does your child experience any of the following?

- Nose bleeds  Frequent ear aches  Learning disability/special education
- Frequent headaches  Fainting spells  ADD/ADHD
- Frequent stomach aches  Bone/muscle disease  Mental health condition (i.e., depression, anxiety, eating disorder)
- Other \_\_\_\_\_

Do any of the above condition(s) limit/effect your child at school? \_\_\_\_\_

### HEARING/VISION

Do you have concerns about your child's hearing?  Yes  No Does your child wear hearing aides?  Yes  No

Do you have concerns about your child's vision?  Yes  No Does your child wear glasses or contacts?  Yes  No

### SPEECH/LANGUAGE

Do you have concerns about your child's speech and/or language?  Yes  No

Do others have difficulty understanding your child?  Yes  No If yes, please explain \_\_\_\_\_

### AUTHORIZATION FOR EMERGENCY MEDICAL TREATMENT

I understand that the information given above will be shared with appropriate school staff to provide for the health and safety of my child. If either I or an authorized emergency contact person cannot be reached at the time of a medical emergency, I authorize and direct school staff to send my child to the most easily accessible hospital or physician. I understand that I will assume full responsibility for payment of any transport or emergency medical services rendered.

Parent/Guardian Signature: \_\_\_\_\_ Date: \_\_\_\_\_

Home phone: \_\_\_\_\_ Parent/Guardian cell: \_\_\_\_\_



Sequim High School  
Registration Planning Form  
9<sup>th</sup> Grade 2020-2021

Student Name: \_\_\_\_\_

Graduation Year: 2024

English Teacher: \_\_\_\_\_

Period: \_\_\_\_\_

- Please take this DRAFT copy home to review with your Parent/Guardian. Bring the DRAFT copy back to transfer your requests to your original registration form on Monday, March 23<sup>rd</sup> in your English Class.
- You must have a complete schedule. If you leave blanks, the counseling office will choose classes for you. The periods of your classes for next year will be selected at random by computer.
- You are only using the computer to choose one elective class for each semester and six (6) semesters of alternate courses.
- Do not forget to fill in alternates in case you do not get the electives you want. Please select elective courses from the list on the back of this form.
- If you plan to take Honors' courses, make sure you check the appropriate boxes.
- *\*Please select the Science Class that best fits your future plans or interests.*
- *\*Math classes will be added by your current year's teacher recommendation\**
- This is a recommended schedule. Please speak to your counselor if you have unique scheduling needs.

First Semester Course Description	Course Code	Second Semester Course Description	Course Code
1) English: 9 <sup>th</sup> Grade English Language Arts Check if applicable: Honors <input type="checkbox"/> <u>ENG711</u>	# <u>ENG101</u>	1) English: 9 <sup>th</sup> Grade English Language Arts Check if applicable: Honors <input type="checkbox"/> <u>ENG712</u>	# <u>ENG102</u>
2) Science: Integrated Science <input type="checkbox"/>  PLTW Principals of Biomed <input type="checkbox"/>  Ag Science <input type="checkbox"/>	# <u>SCI111</u>  # <u>SCI231</u>  # <u>VOC101</u>	2) Science: Integrated Science <input type="checkbox"/>  PLTW Principals of Biomed <input type="checkbox"/>  Ag Science <input type="checkbox"/>	# <u>SCI112</u>  # <u>SCI232</u>  # <u>VOC102</u>
3) Health	# <u>HOM101</u>	3) MS Imagined Academy	# <u>CMP321</u>
4) Math: *Recommended by current math teacher*		4) Math: *Recommended by current math teacher*	
5) PE: Weight Training & Team Sports <input type="checkbox"/> Recreational Activities for Life <input type="checkbox"/>	# <u>PED201</u> # <u>PED351</u>	5) PE: Weight Training & Team Sports <input type="checkbox"/> Recreational Activities for Life <input type="checkbox"/>	# <u>PED202</u> # <u>PED352</u>
6) Elective: _____	# _____	6) Elective: _____	# _____

**Alternates**

~List in order of preference~

1) _____	# _____	2) _____	# _____
3) _____	# _____	4) _____	# _____
5) _____	# _____	6) _____	# _____

English Teacher's Signature: \_\_\_\_\_

**ELECTIVE COURSE SELECTIONS ARE ON THE BACK OF THIS FORM**

Sem 1	Sem 2	Course Description	Grd	Lngh	Sem 1	Sem 2	Course Description	Grd	Lngh
<b>ENGLISH</b>					<b>FINE ARTS</b>				
ENG101	ENG102	9th ENG LANG ARTS	09	Y		ART421	GLASS FUSING	09 - 12	S
ENG711	ENG712	9th HONORS ELA	09	Y	ART161	ART162	PAINTING I / II	09 - 12	S or Y
ENG301	ENG302	10th ENG LANG ARTS	10	Y	ART101	ART102	DRAWING I	09 - 12	S or Y
ENG731	ENG732	10th HONORS ELA	10	Y	ART301	ART302	DRAWING II	10 - 12	S or Y
ENG201	ENG202	11th ENG LANG ARTS	11	Y	ART351	ART352	CERAMICS I	09 - 12	S or Y
ENG801	ENG802	AP ENG LANG/COMP	11	Y	ART355	ART356	CERAMICS II	10 - 12	S or Y
ENG411	ENG412	12th ENG LANG ARTS	12	Y	ART451	ART452	AP STUDIO ART	10 - 12	S or Y
ENG751	ENG752	AP ENG LIT/COMP	12	Y	ART511	ART512	INTRO TO ART	09 - 12	S or Y
<b>MATH</b>					PHO101	PHO102	PHOTOGRAPHY I *	10 - 12	S or Y
MTH191	MTH192	ALGEBRA I	09 - 12	Y	PHO201	PHO202	PHOTOGRAPHY II *	11 - 12	S or Y
MTH195	MTH196	INTENSIFIED ALGEBRA	09	Y	MUL101	MUL102	MULTIMEDIA I *	09 - 12	S or Y
MTH201	MTH202	GEOMETRY	09 - 12	Y	MUL201	MUL202	MULTIMEDIA II *	10 - 12	S or Y
MTH221	MTH222	HON GEOMETRY	09 - 10	Y	DRA201	DRA202	DRAMA	09 - 12	S or Y
MTH301	MTH302	ALGEBRA II	09 - 12	Y	VOC251	VOC252	FLORAL DESIGN I/II *	09 - 12	S or Y
MTH303	MTH304	ALGEBRA II HON	09 - 11	Y	MUS101	MUS102	CONCERT BAND	09 - 12	S or Y
MTH351	MTH352	BRIDGE TO COLLEGE MTH	11 - 12	Y	MUS151	MUS152	SHS CHOIR	09 - 12	S or Y
MTH401	MTH402	AP STATISTICS	11 - 12	Y	MUS181	MUS182	VOCAL ENSEMBLE	09 - 12	Y
MTH511	MTH512	MATH120 PRE CALC - UW	10 - 12	Y	MUS201	MUS202	WIND ENSEMBLE	10 - 12	Y
MTH801	MTH802	AP CALC LANG AB	11 - 12	Y	MUS261	MUS262	SELECT CHOIR	09 - 12	Y
MTH810	MTH811	AP CALCULUS BC	11 - 12	Y	MUS301	MUS302	HR JAZZ ENSEMBLE	09 - 12	Y
<b>SOCIAL STUDIES</b>					MUS351	MUS352	PERCUSSION ENSEMBLE	09 - 12	Y
	SOC241	WESTERN CIV	10	S	MUS501	MUS502	AP MUSIC THEORY	11 - 12	Y
	SOC741	HON WEST CIV	10	S	MUS271	MUS272	MUSIC PRODUCTION I	09 - 12	S or Y
SOC301	SOC302	US HISTORY	11	Y	MUS273	MUS274	MUSIC PRODUCTION II	10 - 12	S or Y
SOC901	SOC902	AP US HISTORY	11	Y	<b>CAREER - TECH ED</b>				
SOC451	SOC452	CIVICS/CONTEMPORARY ISSUES	12	Y	CMP321	MS IMAGINE ACAD	09 - 12	S	
SOC911	SOC912	AP GOVERNMENT	12	Y	BUS311	PERSONAL FINANCE	09 - 12	S	
<b>LAB SCIENCE</b>					BUS312	BUSINESS MATH	09 - 12	S	
SCI111	SCI112	INTEGRATED SCI I	09 - 12	Y	BUS451	INTRO TO LAW	09 - 12	S	
SCI231	SCI232	PLTW PRINC BIOMED I **	09 - 12	Y	BUS151	SPORT ENTRTNMNT MARKETING	09 - 12	S	
SCI233	SCI234	PLTW BIO HUM BODY II **	10 - 12	Y	BUS160	FASHION MARKETING	09 - 12	S	
SCI235	SCI236	PLTW BIO MED INT III **	11 - 12	Y	HOM401	REAL WORLD	09 - 12	S	
SCI961	SCI962	AP BIOLOGY	10 - 12	Y	CSC361	VIDEO GAME DESIGN	09 - 12	S	
SCI471	SCI472	CHEMISTRY	10 - 12	Y	CSC201	CSC202	COMP PROG I / II	09 - 12	S or Y
SCI965	SCI966	CHEM 110 - UW	10 - 12	Y	CSC351	CSC352	CISCO I	10 - 12	Y
SCI461	SCI462	PHYSICS	11 - 12	Y	CSC701	CSC702	AP COMP SCIENCE **	10 - 12	Y
SCI931	SCI932	AP PHYSICS I	11 - 12	Y	CSC751	CSC752	AP COMP SCI PRINCIPLES	09 - 12	Y
VOC101	VOC102	AG SCI I **	09 - 12	Y	CTE511	CTE512	PLTW ENGINEER I **	09 - 12	Y
VOC375	VOC376	AG BIOLOGY-ANIMAL**	10 - 12	Y	CTE513	CTE514	PLTW ENGINEER II AEROSP **	10 - 12	Y
VOC373	VOC374	AG BIOLOGY-PLANT **	10 - 12	Y	ELE451	ELE452	YEARBOOK	09 - 12	Y
CTE311	CTE312	VET SCIENCE I **	11 - 12	Y	VOC111	VOC112	CAD I	09 - 12	Y
CTE313	CTE314	VET SCIENCE II **	12	Y	VOC221	VOC222	CAD II	10 - 12	Y
CTE321	CTE322	FOOD SCIENCE AND SAFETY**	11 - 12	Y	VOC393	VOC394	CAD 3D MODELING	10 - 12	Y
<b>PHYSICAL EDUCATION / HEALTH</b>					VOC411	VOC412	CAD ARCHITECTURE	10 - 12	Y
	HOM101	FAMILY HEALTH	09	S	VOC121	VOC122	WOOD I	09 - 12	Y
PED099	PED100	PE LEADERSHIP	09 - 12	S or Y	VOC551	VOC552	WOOD II CABINET MAKING	10 - 12	Y
PED201	PED202	WEIGHT TRAIN & TEAM SPORTS	09 - 12	S or Y	VOC141	VOC142	WELDING I	09 - 12	S or Y
PED351	PED352	REC ACTIVITIES FOR LIFE	09 - 12	S or Y	VOC201	VOC202	WELDING II	10 - 12	S or Y
PED401	PED402	ADV PHYS FITNESS 0 HOUR	09 - 12	S or Y	VOC231	VOC232	INTRO AUTO MECHANICS	09 - 12	Y
<b>WORLD LANGUAGE</b>					VOC511	VOC512	AUTO TECHNICIAN	09 - 12	Y
WLG101	WLG102	SPANISH I	09 - 12	Y	VOC381	VOC382	CULINARY ARTS I	09 - 12	S or Y
WLG201	WLG202	SPANISH II	09 - 12	Y	VOC421	VOC422	CULINARY ARTS II	10 - 12	S or Y
WLG301	WLG302	SPANISH III	09 - 12	Y	VOC541	VOC542	VIDEO PRODUCTION - GNN	09 - 12	Y
WLG471	WLG472	AP SPANISH LANG & CULTURE	11 - 12	Y	VOC561	VOC562	ROBOTICS I	09 - 12	Y
WLG121	WLG122	AMERICAN SIGN LANGUAGE I	09 - 12	Y	VOC571	VOC572	ROBOTICS II	10 - 12	Y
WLG221	WLG222	AMERICAN SIGN LANGUAGE II	10 - 12	Y	MUL101	MUL102	MULTIMEDIA I *	09 - 12	S or Y
<b>ELECTIVE</b>					MUL201	MUL202	MULTIMEDIA II *	10 - 12	S or Y
	SOC221	ANTHROPOLOGY	09 - 12	S	PHO101	PHO102	PHOTOGRAPHY I *	10 - 12	S or Y
	SOC250	SOCIOLOGY	09 - 12	S	PHO201	PHO202	PHOTOGRAPHY II *	11 - 12	S or Y
ELE111	ELE112	STUDY SKILLS	09 - 12	S or Y	VOC251	VOC252	FLORAL DESIGN I / II *	09 - 12	S or Y
ELE501	ELE502	LEADERSHIP	09 - 12	Y	TEA501	TEA502	STAFF ASSISTANT	09 - 12	S or Y
SOC351	SOC352	PSYCHOLOGY	09 - 12	S or Y					

**NOTES**

* INDICATES CLASSES THAT COUNT FOR ART OR CTE
**INDICATES CLASSES THAT COUNT FOR SCIENCE OR CTE
COURSE CODES LISTED ONLY ONCE CAN BE TAKEN EITHER SEMESTER